



NOTICE OF ROAD CLOSURE

Thursday, October 20, 2022

7:00 am – 4:00 pm

Concession 8

**Between Wellington Road 11 and Sideroad 15
(work will take place between #8012 & #8008)
(map attached)**

**Date &
Time Closed: Thursday, October 20, 2022 at 7:00 am**

**Date &
Time Reopened: Thursday, October 20, 2022 at 4:00 pm**

Reason: Culvert Replacement

**NO THROUGH TRAFFIC
LOCAL TRAFFIC ONLY FROM EITHER END**

**Access to #8012 from Sideroad 15
Access to #8008 from Wellington Road 11**



Explore Wellington

ROAD CLOSURE - CONCESSION 8

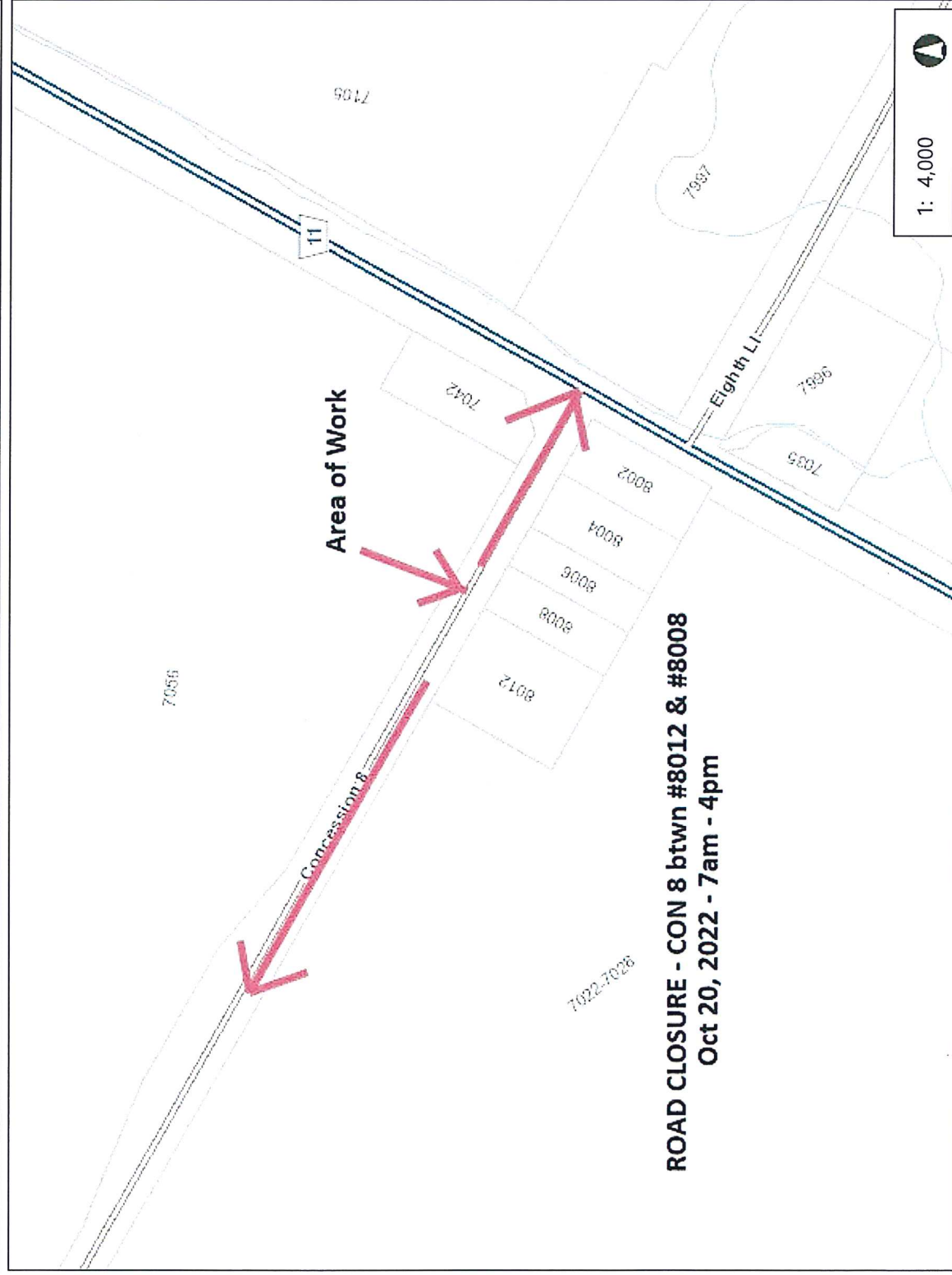

ROAD CLOSURE - CON 8 btwn #8012 & #8008

Oct 20, 2022 - 7am - 4pm

Legend

	Municipal Offices		Local Road
	OPP Stations		County Road
	Hospitals		Highway
	Fire Stations		Railways
	Information Centres		Trails
	Schools		Waterbodies
	Post Offices		Watercourses
	Arenas		Parks
	Community Centres		Urban Centres and Hamlets
	Curling Rinks		Municipalities
	Libraries		
	Museums		
	Park Parking Lots		
	County Garages		
	Parcels		
	Roads		

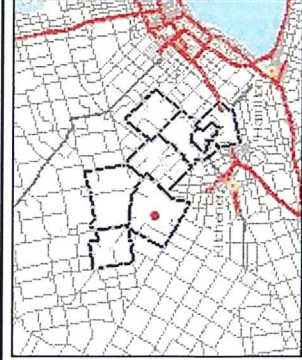

0.2 0 0.10 0.2 Kilometers

1: 4,000

This map is a user generated static output from an Internet mapping site and is for reference only. Data layers that appear on this map may or may not be accurate, current, or otherwise reliable.

Produced using information under License with the Grand River Conservation Authority. Copyright © Grand River Conservation Authority, 2022.

THIS IS NOT SURVEY DATA. Parcels - Teranet 2002, Wellington County 2022

WGS_1984_Web_Mercator_Auxiliary_Sphere
Includes material © 2022 of the Queen's Printer for Ontario. All rights reserved.

Notes

Road Closure - Con 8 btwn 8012 & 8008
Oct 20, 2022 - 7am - 4pm